

Top of Show Props Preset	
Stage Left Prop Table	Stage Right Prop Table
<ul style="list-style-type: none"> ○ 1 round ornate silver tray with handles ○ 1 cigar and lighter (Don Alfonso) ○ 1 martini glass with water and olives on skewer ○ 3 Newspapers ○ 2 small black pillows ○ 2 baskets, 1 filled with 10 crumpled pieces drawing paper ○ large piece of black lace to cover umbrella in I, iv ○ Black fabric to cover umbrella pole in I, iv ○ Stack of paper money folded in half (Don Alfonso) ○ 2 wedding contracts (Despina) ○ 2 Black fountain pens ○ 2 flower pots 	<ul style="list-style-type: none"> ○ 1 cane (Don Alfonso) ○ 1 extra stack of paper money folded in half (for Don Alfonso, just in case) ○ 2 valises (Ferrando/Guglielmo) ○ 1 round ornate silver tray with handles: <ul style="list-style-type: none"> ○ 2 cognac glasses filled with "cognac" ○ 2 martini glasses, filled with H2O ○ 1 larger oval silver tray with handles: <ul style="list-style-type: none"> ○ 3 wine glasses, filled with a little "wine" ○ 1 empty wine bottle with white label and cork ○ 1 black fountain pen ○ 1 small ashtray with small amount of H2O ○ 2 poison bottles (Ferrando/Guglielmo) ○ 2 baskets filled with crumpled paper ○ Copy of Guglielmo sketch ○ Copy of Ferrando (Black) sketch ○ Despina's machine and wand ○ Round table's table cloth ○ 18 tea lights ○ 1 round plain silver tray with "creamy" pastries ○ 1 round plain silver tray with cookies ○ 1 round plain silver tray with: <ul style="list-style-type: none"> ○ 2 teacups, 2 saucers, 2 spoons, 2 napkins ○ 2 small baskets with flower petals ○ 12 matching wine glasses (for Chorus)--filled with "wine" ○ 2 military sabers ○ 2 flower pots
Dressing Room Presets:	
<ul style="list-style-type: none"> ○ Paper money--Don Alfonso, Ferrando, Guglielmo (DONE BY STAGE MANAGEMENT) 	

Top:

Tea Cart Preset Detail:

Side:

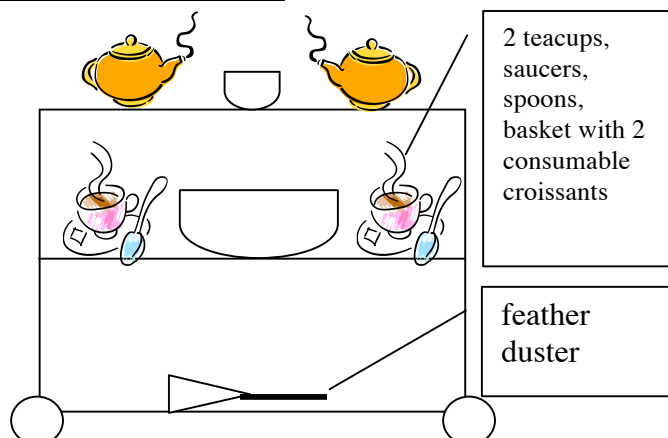
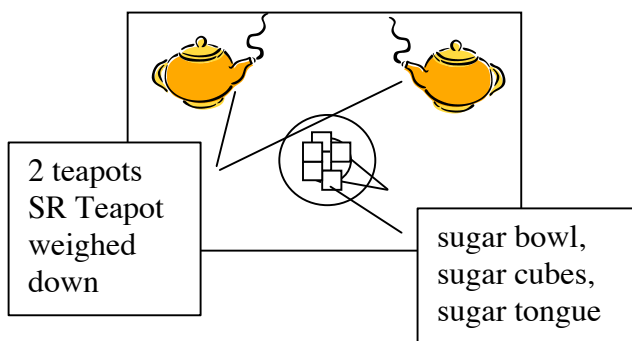

SR Table:

Vanity Tables Detail:

SL Table:

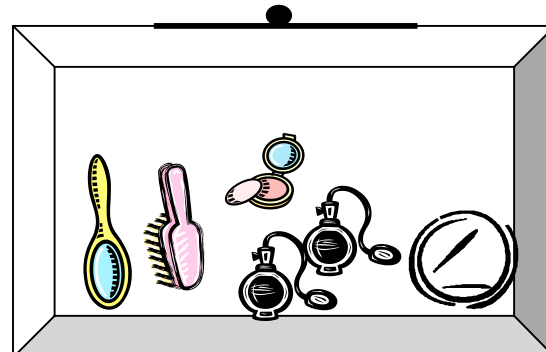
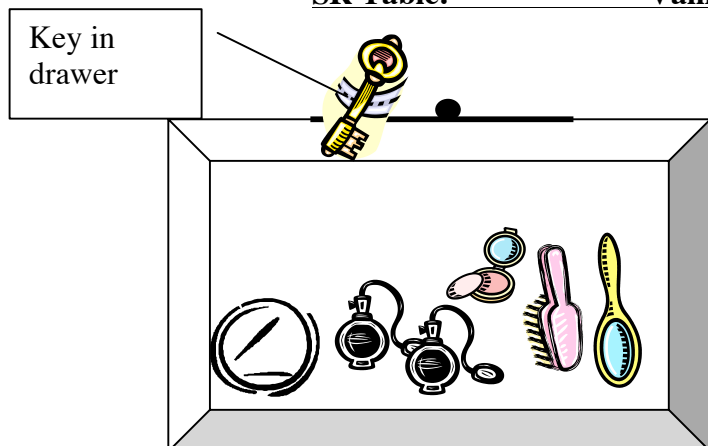

Preset on each table: 1 standing mirror, 2 atomizers, 1 makeup compact, 1 hairbrush, 1 hand mirror.

- 2 pedestals
2 white chairs

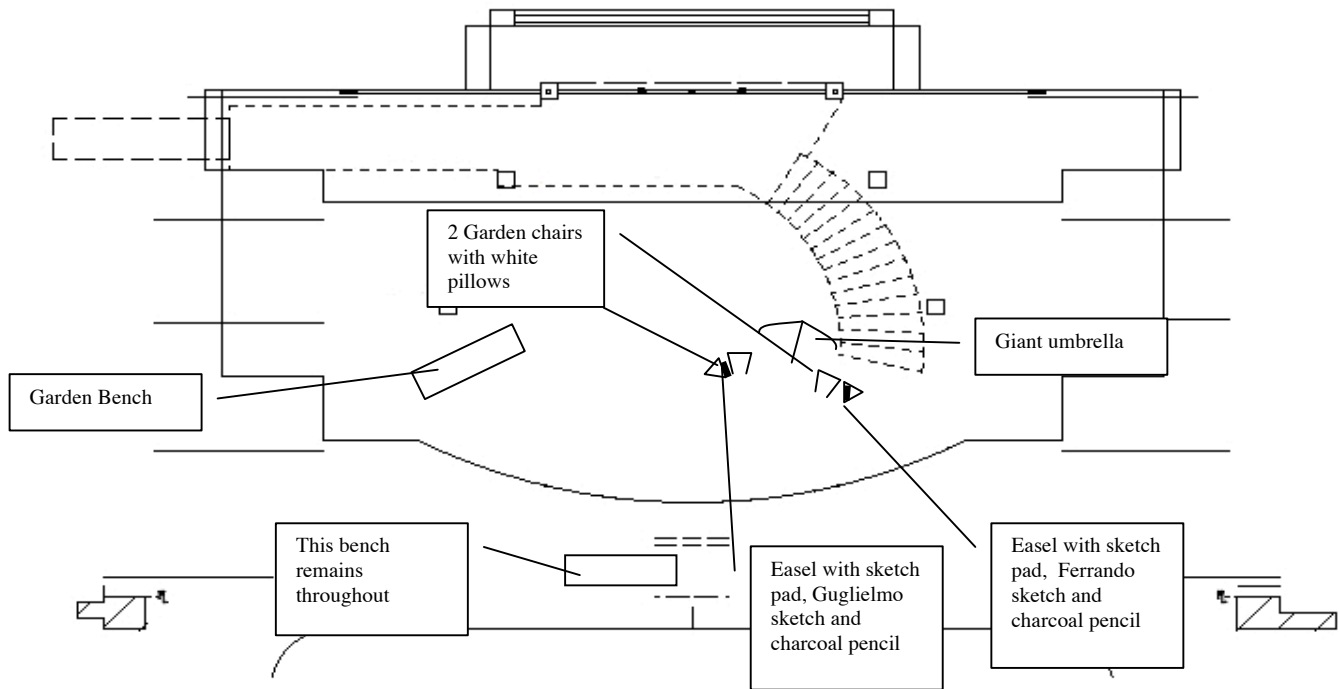

Time	Where	What	Who
-30:00		Wash glasses. Get consumables ready. Sweep petals off stage and reset for top of show. Check batteries in Despina's Machine and candelabras.	Props
TOP	SL 1	CATCH: Lighter from Don Alfonso (Kris Irmiter) after he lights his cigar	Tara
5:30	SR 3	CATCH: 1 ornate silver tray (Doug Sea) RESET: Add 2 filled martini glasses TRACK: to SR props table	Larry
7:30	SR3	CATCH: 1 ornate silver tray with 2 cognac glasses (Harrison Bumgardner) TRACK: SR props table	Larry
11:00	SR 3	CATCH: Larger silver tray with 3 wine glasses, ashtray, and cigar (Jen Reid) TRACK: SR props table	Larry
Shift to Act I, scene 2a--The Garden (Green)			
Time	Where	What	Who
11:15		CHORUS STRIKE: Pool Table (SL 2), 6 Chairs CHORUS SET: SR Bench (SR 3), 2 Garden Chairs and 2 Easels with sketch pads, sketches and charcoals(SL 1)	Chorus
	SL 2	TRACK: 4 elegant chairs to SL props, other 2 chairs are dead. Pool Table is Dead.	Tara
Shift to Act I, scene 2b			
Time	Where	What	Who
22:00		CHORUS STRIKE: 2 Garden Chairs and 2 Easels with drawing pads, sketches and charcoals (SL 2)	Chorus
When Shift Complete	SL/SR	TRACK: REMOVE sketches from sketch pads on easels SL. CHANGE: Exchange white pillows on garden chairs for black pillows SL. ADD black lace to umbrella and umbrella pole. PRESET FOR NEXT SHIFT: SL Vanity/Stool□SL 1, Recamier□SL 2, Folding Screen□SL 4, SR Vanity/Stool□SR 1, Tea Cart□SR 2, SR Recamier □SR 2	Props

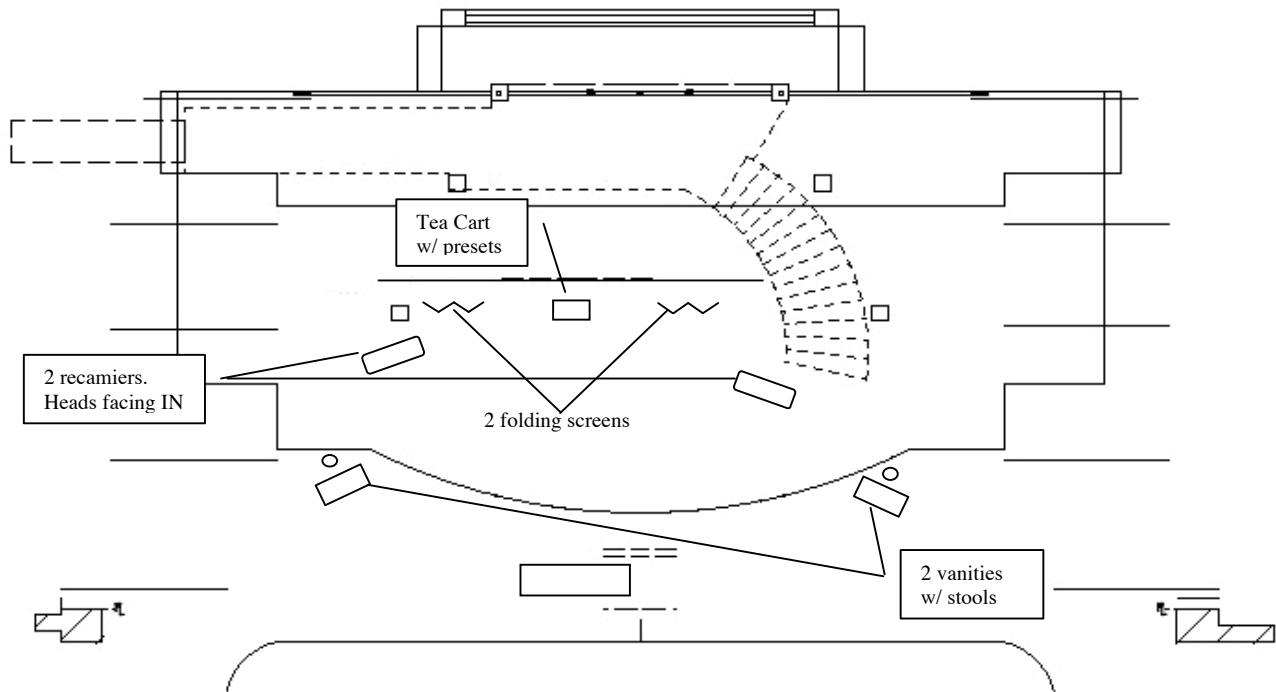

Shift to Act I, scene 3--The Bedroom (Red)

Time	Where	What	Who
31:00		CHORUS STRIKE: SR Bench (SR 3) CHORUS SET: SR Vanity/Stool (SR 1), Tea Cart (SR 2), SR Recamier (SR 3) SR Screen (SR 4), SL Vanity/Stool (SL 1), SL Recamier (SL 2), SL Screen (SL 4), UC Pedestal/Flowerpot (SR 4)	Chorus
	SR 3	CATCH: SR Bench #2	Larry
When shift complete	SL/SR	PRESET FOR NEXT SHIFT: SR Bench □ SR 3, 2 Garden Chairs with black pillows and 2 Easels with blank sketch pads □ SL 2, Umbrella with black lace □ SL 3, 2 paper baskets □ SL Boom 3	
32:00	SR 3	HANDOFF: 2 sketch portrait copies	Larry
40:00	SR 3	CATCH: 2 sketch portrait copies	Larry
40:00	SL 1	CATCH: 1 Teapot	Tara
46:30	SR 3	HANDOFF: Cane to Don Alfonso	Larry

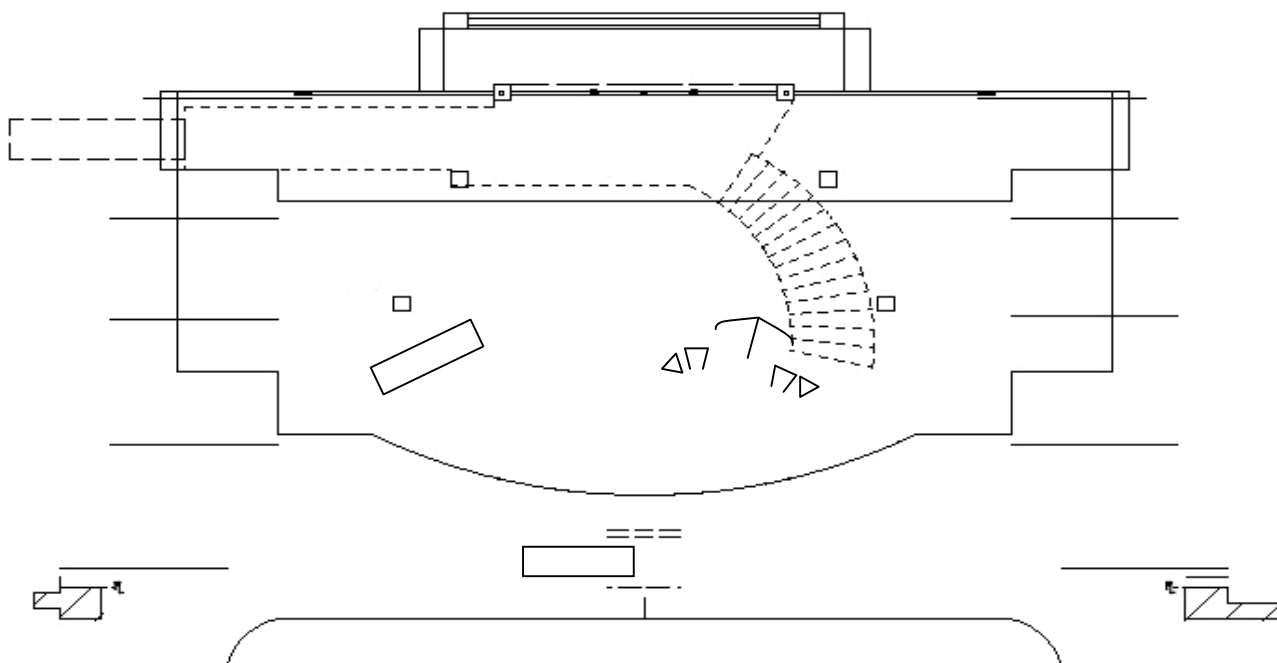

Shift to Act I, scene 4a--The Garden (Green)

Time	Where	What	Who
59:30		CHORUS STRIKE: SR Vanity/Stool (SR 1), Tea Cart (SR 2), SR Recamier (SR 2) SR Screen (SR 3), SL Vanity/Stool (SL 1), SL Recamier (SL 2), SL Screen (SL 4), UC Pedestal/Flowerpot (SR 4). Tea Cart is Dead. CHORUS SET: SR Bench (SR 3), 2 Garden Chairs and 2 Easels with sketch pads (SL 2), Umbrella (SL 3), 2 paper baskets (SL Boom 3)	Chorus

Shift to Act I, 4b

Time	Where	What	Who
67:30		CHORUS STRIKE: 2 Garden Chairs and 2 Easels (SL 2). Chairs and Easels are Dead.	Chorus
	SL 3	CATCH: Umbrella, help clear furniture from shift if traffic gets clogged Umbrella is Dead.	Tara
70:30	SR 3	HANDOFF: Machine to Despina--make sure set on SILENT (She'll be coming from 2:00 Quick Change)	Larry

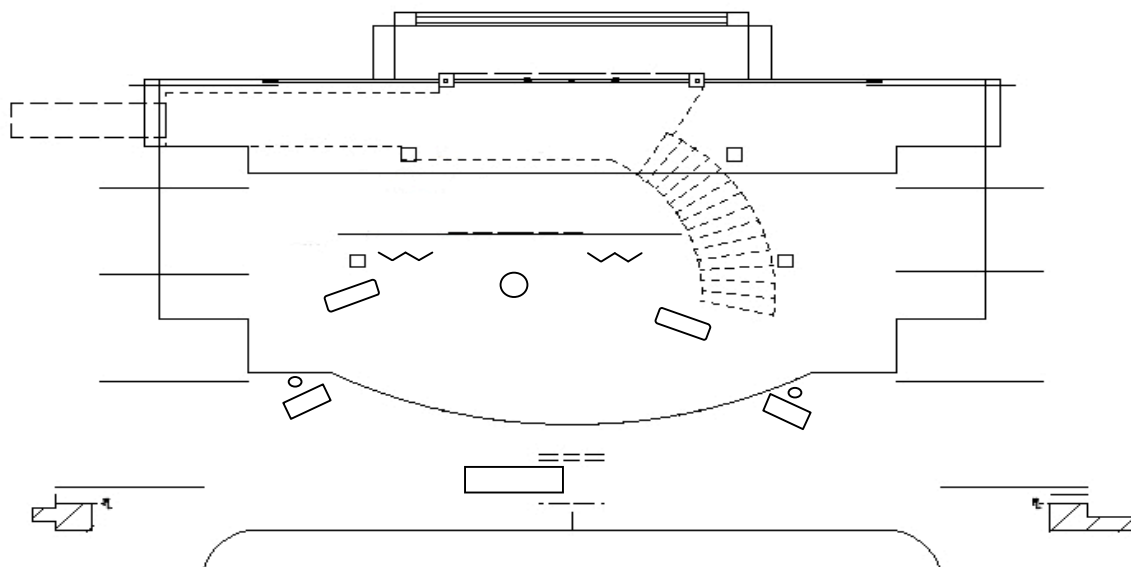

Intermission (25:00) Shift to II-1 Bedroom (Red)			
Time	Where	What	Who
TOP		<p>STRIKE: SR Bench (SR 3), 2 poison bottles, Despina's machine and wand.</p> <p>SET: SR Vanity/Stool, SR Recamier, SR Screen, SL Vanity/Stool, SL Recamier, SL Screen, Round table, UC Pedestal/Flowerpot 1 Newspaper on each Recamier (Newspapers on SL Props Table)</p> <p>PRESET FOR NEXT SHIFT: SR Bench□SR 3, SL Bench□SL 2</p>	Tara/Larry

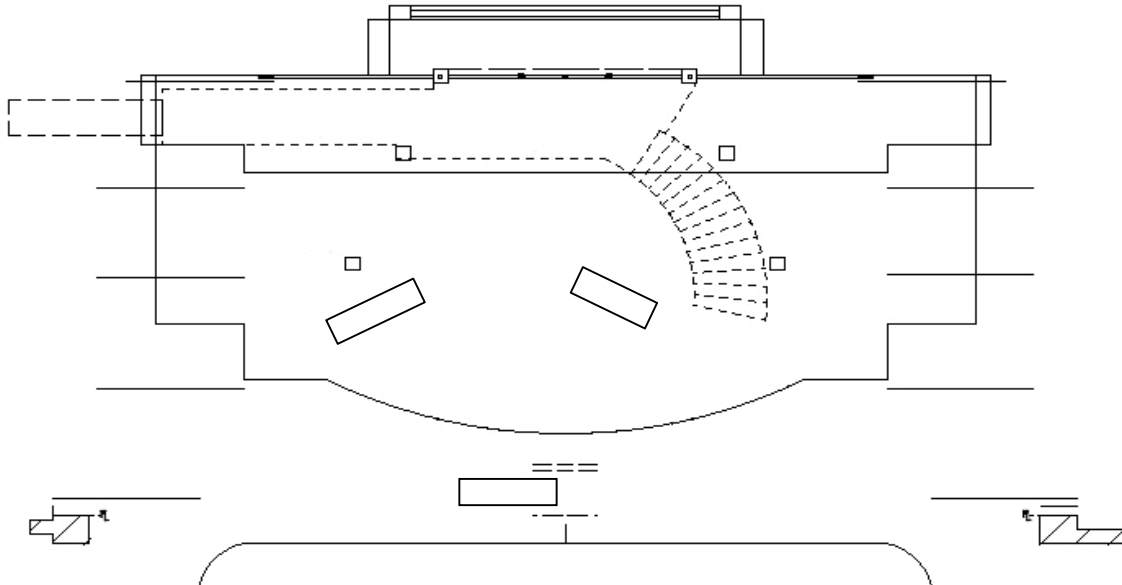

Shift to Act II-2, Scene 2--Garden (Green)			
Time	Where	What	Who
10:00		CHORUS STRIKE: SR Vanity/Stool (SR 1), SR Recamier (SR 2) SR Screen (SR 3), SL Vanity/Stool (SL 1), SL Recamier (SL 2), SL Screen (SL 4), Round Table (SR 3), UC Pedestal/Flowerpot (SR 4), 2 White Chairs (SL 2). White Chairs are Dead. CHORUS SET: SR Bench (SR 3), SL Bench (SL 2)	Chorus
	SR 3	CATCH: Folding Screen, Round Table, pedestal and flower pot from Kelly Parker	Larry
	SR	TRACK: Round Table to SL (food items, trays, cups on it are dead)	John
	SR/SL	TRACK: Remove newspapers from Recamiers, track to SL props table.	Larry/Tara
When shift complete	SR/SL	PRESET FOR NEXT SHIFT: SR Vanity/Stool□SR 1, SR Recamier□SR 2, SR Screen□SR 3, SL Vanity/Stool□SL 1, SL Recamier□SL 2, SL Screen□SL 4	Props

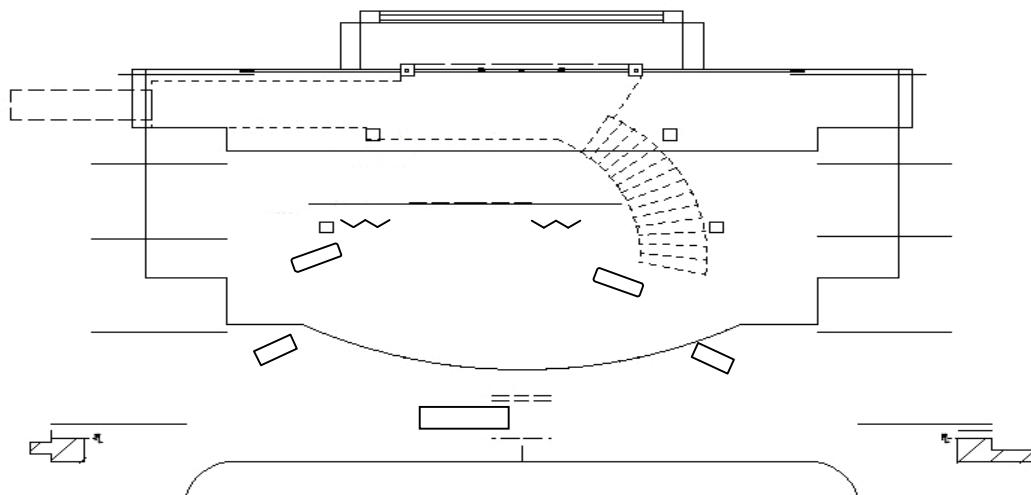

Shift to Act II, scene 3--Bedroom (Red)

Time	Where	What	Who
35:30		CHORUS STRIKE: SR Bench (SR 3), SL Bench (SL 2). CHORUS SET: SR Vanity/Stool (SR 1), Tea Cart (SR 2), SR Recamier (SR 2) SR Screen (SR 3), SL Vanity/Stool (SL 1), SL Recamier (SL 2), SL Screen (SL 4)--Screen may come thru SL 2 if door is blocking entrance.	Chorus
	SR 4	SET: UC Pedestal and flower pot	Larry
	SL 2	STORE: Bench. Bench is dead.	Tara
	SR 3	CATCH: Bench (H. Bumgardner) if necessary. Bench is dead.	Larry
42:00	SR 3	CATCH: Martini glass from Dorabella	Larry
42:30	SR 3	CATCH: Key from Despina HANDOFF: 2 military sabers to Despina	Larry
When shift complete	SL/SR	PRESET FOR NEXT SHIFT: Banquet Table □SL 2 area, 2 pedestals□SL 4, 2 pedestals□SR 4, 2 Flower pots□SR dead bench, 2 Flower Pots□Round Table. Move Banquet Table props and 2 contracts/2 fountain pens □Round Table.	Larry-SR Tara-SL

ROUND TABLE BANQUET PROPS PRESET FOR HANDOFF:

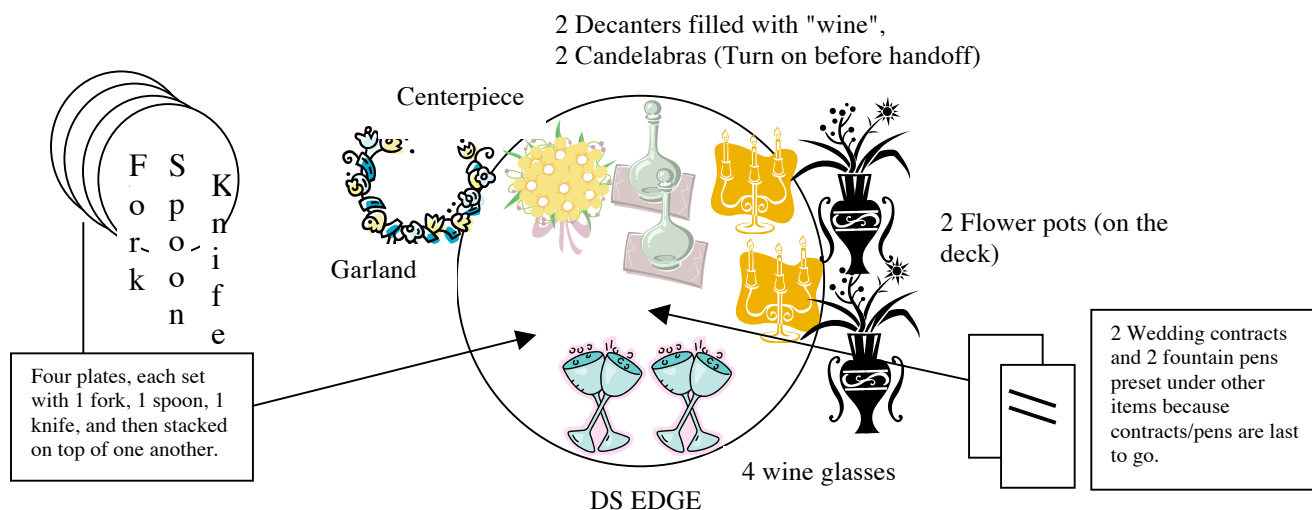

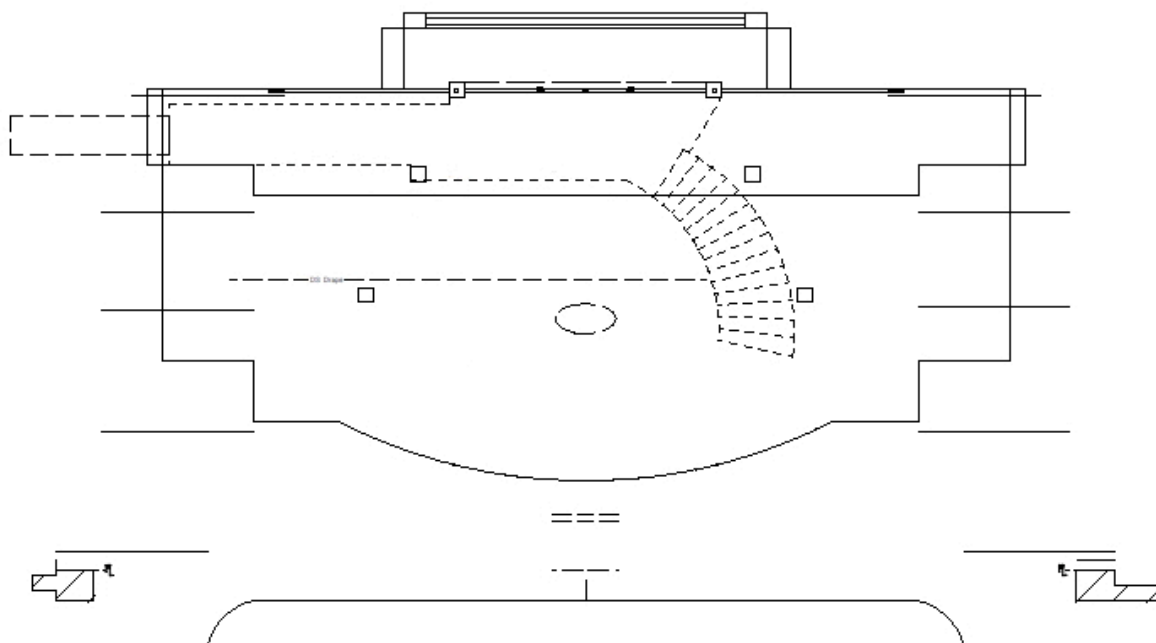

Shift to Act II, Scene 4--The Banquet (Blue)			
Time	Where	What	Who
51:30		CHORUS STRIKE: SR Vanity/Stool (SR 1), Tea Cart (SR 2), SR Recamier (SR 3) SR Screen (SR 4), SL Vanity/Stool (SL 1), SL Recamier (SL 2), SL Screen (SL 4). All bedroom furniture is dead. CHORUS SET: Banquet Table, table dressing, 4 elegant chairs (SL 1)	Chorus
	SL4/ SR 4	SET DURING SHIFT: 4 Pedestals (Larry --SR, John--SL). 1 SR Pedestal is already onstage from previous scene and will only need to be moved SR a few feet.	John, Larry
	SL 2	HANDOFF: flower pots, 2 decanters, 2 candelabras (lit).	Tara
54:00	SL 3	HANDOFF: 2 contracts and 2 fountain pens to Despina (She'll be coming from QC. Please have these ready in case QC takes longer than estimated.)	Tara
61:00	SR 1	HANDOFF: Valises to Ferrando/Guglielmo	Larry
End of Show	Onstage	Turn OFF Candelabras	Props